



# TECAPRES®

Ø50mm  
1200daN

# TITAN 50

VDI SAFETY



PED  
2014/68/EU

COMPACT  
EXTRA  
POWER

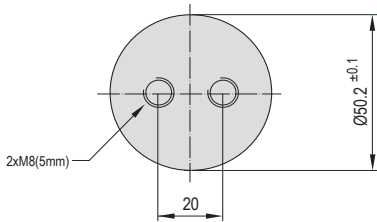
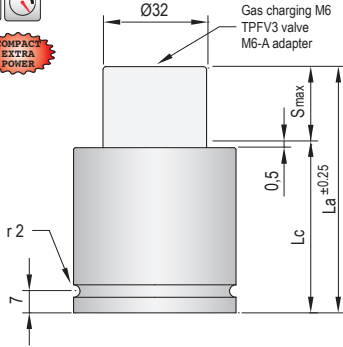

**i** Pressure medium **Nitrogen (N<sub>2</sub>)**

Max. charging pressure	150 Bar
Min. charging pressure	50 Bar
Rod seal area	8,04 cm <sup>2</sup>
Operating temperature	0°C - 80°C
Force increase by temperature	0,33 %/°C
Max. stem speed	0,8 m/s
Maintenance kit	Kit T50



Maximum strokes / minute (at 20°C)

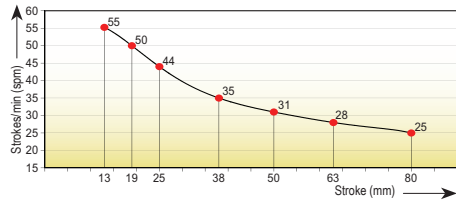

Code	Smax mm	La mm	Lc mm		Fa daN		F daN		Fc daN		P Bar	V l		Kg		
TITAN 50x13	13	55	42	1200 ±5% (20°C)	1965		1965		2215	150 (20°C)	0,023	0,49		0,49		
TITAN 50x19	19	67	48				1950		2190						0,034	0,52
TITAN 50x25	25	79	54				1940		2175						0,045	0,59
TITAN 50x38	38	105	67				1930		2160						0,069	0,68
TITAN 50x50	50	129	79				1925		2155						0,091	0,79
TITAN 50x63	63	155	92				1920		2150						0,114	0,95
TITAN 50x80	80	189	109				1920		2150						0,146	1,10

Force/stroke ratio

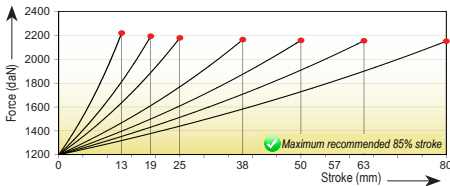

Initial force/charging pressure ratio

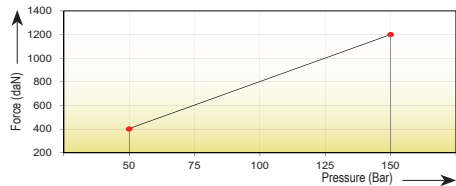

Assembly possibilities



Follow guidelines  
Page 287



DROP-IN



SCREWS



FS 50-FSC 50



FB 45-FB 50

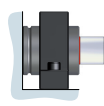

FI 50-FI 50/1

TITAN

TPH

TPS

TPSP

TPF

TPK

TPC

TPR

TPB

TPHC

TPA

TPG

TPCT

TPSL

STOP CYLINDER

STOP CYLINDER

TPSR

TPSR5

TPNS

TPHT

